

Courses & Distance
Up Susquehanna River
 N 3. W 72
 North 14
 N 10 E 25
 N 14 E 36.
 147.

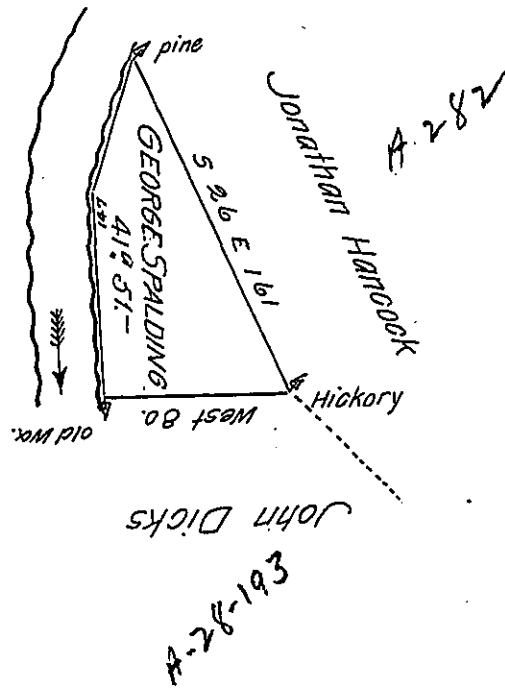

In pursuance of a Warrant Dated 30th March 1793 Surveyed the 17th day of Oct. 1794 to George Spalding the above Described Tract of Land Situate on the east side of the Susquehanna River about half a mile below Tioga point in Luzerne County Containing forty one acres and fifty one perches and the allowance of six P. Cent.

Anty Crothers D.S.

*To Dan! Brodhead Esquire }
 Surveyor Gen! }*

IN TESTIMONY that the above is a copy of the original remaining on file in the Department of Internal Affairs of Pennsylvania, made conformably to an Act of Assembly approved the 16th day of February, 1833, I have hereunto set my Hand and caused the Seal of said Department to be affixed at Harrisburg, this tenth day of December 1906.

Geo. D. Brown
 Secretary of Internal Affairs.